

LGATE-952 Universal Gateway

Installation instructions

Instructions de montage

Montageanweisung

Montagevoorschrift

Istruzioni di montaggio

Instrucciones de montaje

Monteringsanvisning

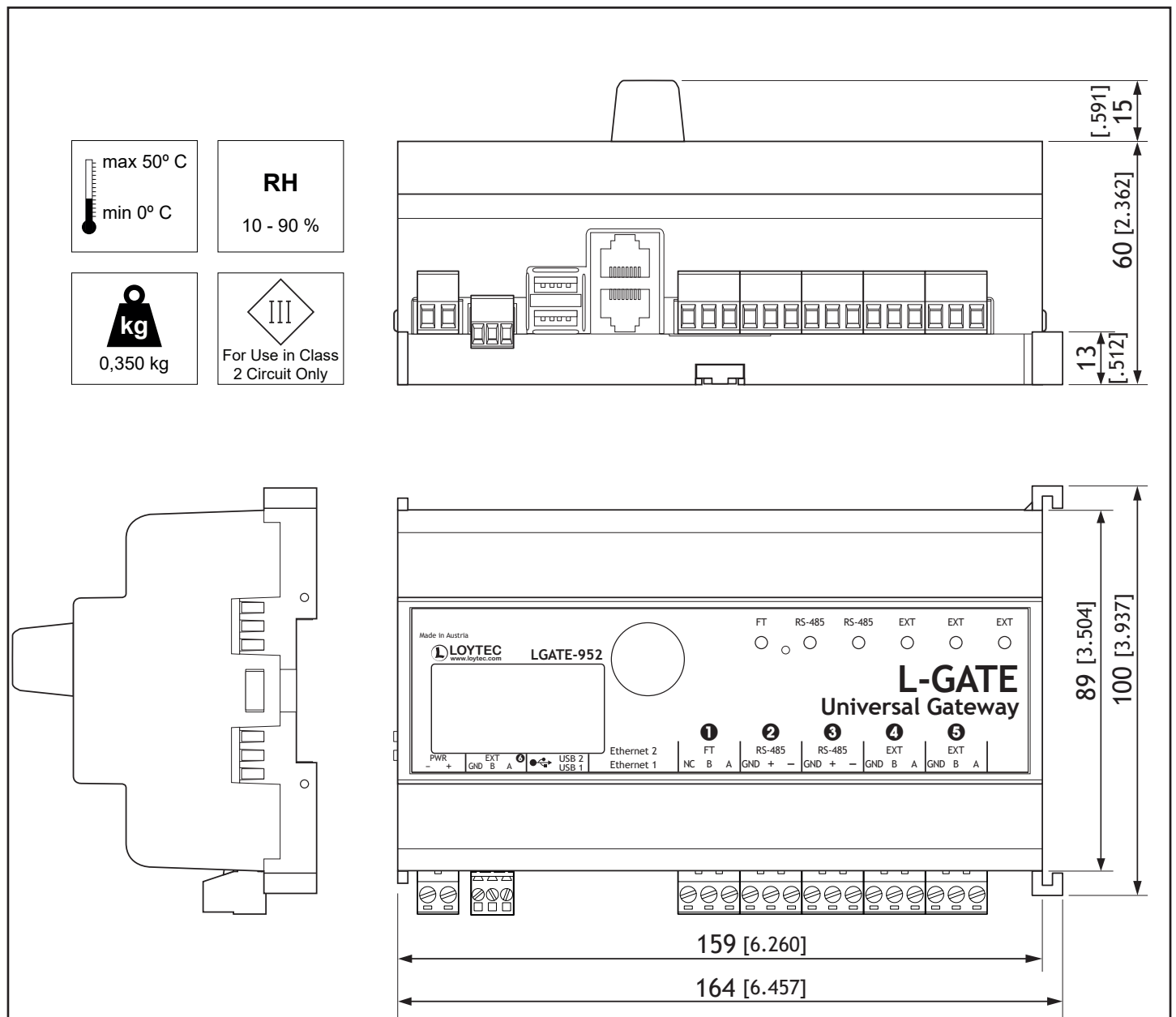

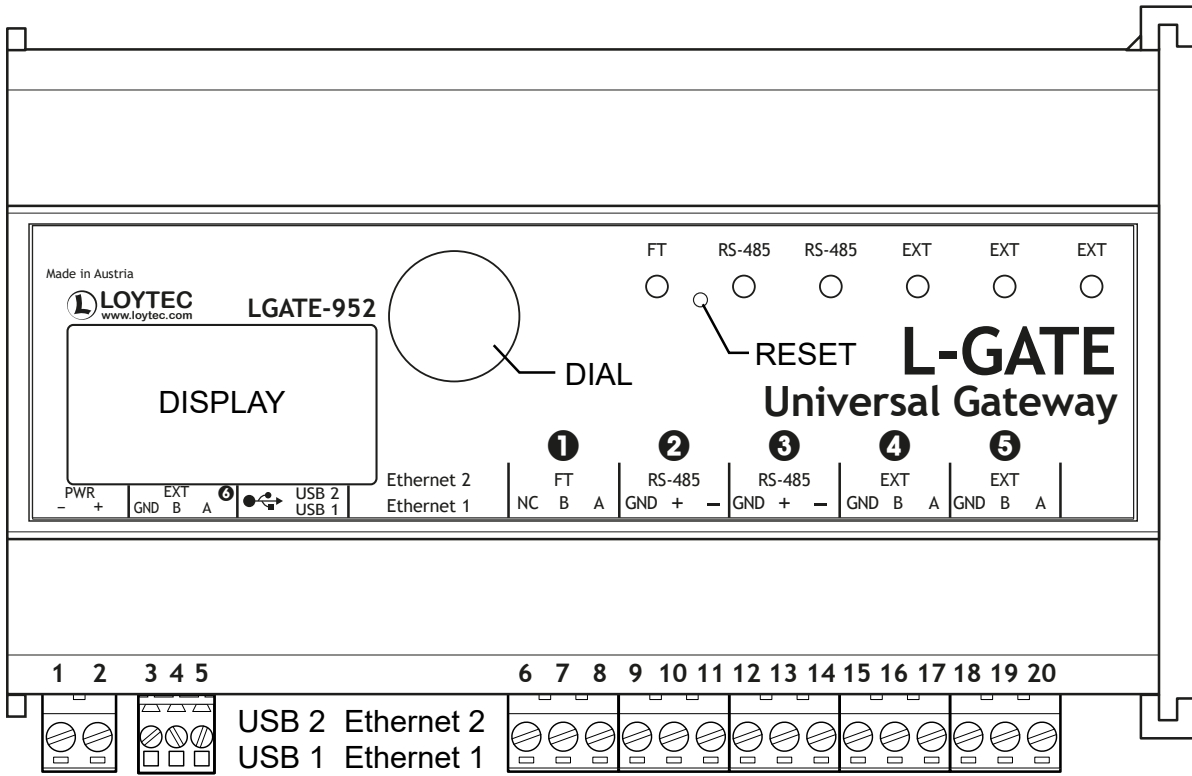

| Connectors | | |
|----------------------------------|----|--|
| POWER 24 V DC/ VAC SELV | 1 | Power supply input - |
| | 2 | Power supply input + |
| | | Input + must NOT be connected to EARTH GND |
| EXT PORT 6 | 3 | GND |
| | 4 | B |
| | 5 | A |
| CEA-709 TP/FT-10 PORT 1 | 6 | NC |
| | 7 | B |
| | 8 | A |
| RS-485 PORT 2 | 9 | GND |
| | 10 | + |
| | 11 | - |
| RS-485 PORT 3 | 12 | GND |
| | 13 | + |
| | 14 | - |
| | | |
| EXT PORT 4 | 15 | GND |
| | 16 | B |
| | 17 | A |
| EXT PORT 5 | 18 | GND |
| | 19 | B |
| | 20 | A |

| Connectors | | |
|------------|-------|--------------------|
| USB1 | USB-A | USB Device |
| USB2 | USB-A | USB Device |
| USB | μ-USB | PC |
| Ethernet1 | RJ45 | 10/100Base-T |
| Ethernet2 | RJ45 | 10/100Base-T |
| Buttons | | |
| RESET | | Reset |
| DIAL | | Turn-and-Push Dial |

4.5 lb-in/0.5 Nm

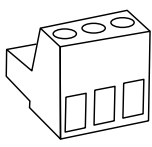

Weidmüller
BLZP 5.08/03/180
BLZP 5.08/02/180
BL 3.50/03/180 SN OR BX

Weidmüller
BL 5.08
0.2 - 2.5 mm²

Weidmüller
BL 3.5
0.2 - 1.5 mm²

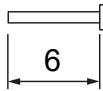
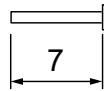

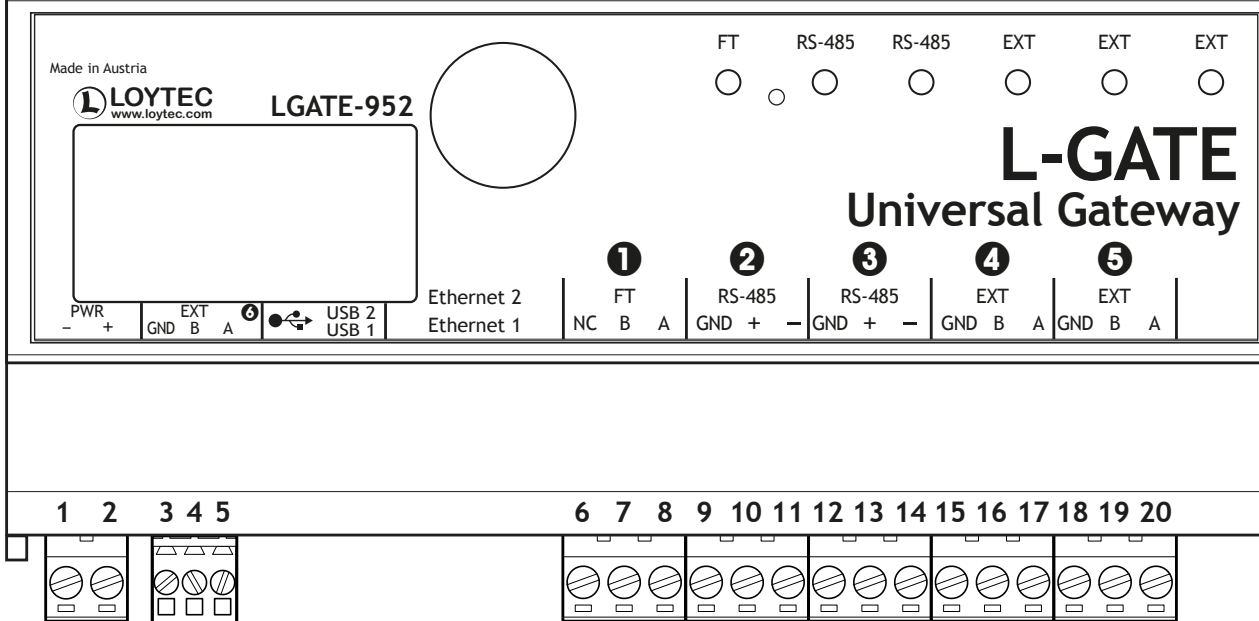

| STATUS LEDs | | |
|----------------------------------|---|--|
| FT | GREEN flashing fast GREEN flashing 1 Hz RED permanent RED flashing fast | Traffic on CEA-709 port Not commissioned CEA-709 port damaged CEA-709 traffic overload |
| RS-485 MODBUS MS/TP | GREEN flashing RED flashing GREEN flashing fast ORANGE flicker RED permanent RED flashing fast | Modbus traffic Transmission errors Token ok, traffic Single master, traffic Token lost, cable damage Communication errors |
| EXT | GREEN GREEN flashing RED permanent RED flashing fast | M-Bus/KNX link M-Bus/KNX activity M-Bus/KNX port damaged M-Bus/KNX traffic overload |

Please update the firmware of the device first,
 see www.loytec.com

35 mm x 7.5 mm DIN rail (EN 50022, BS 5584, DIN 46277-3)

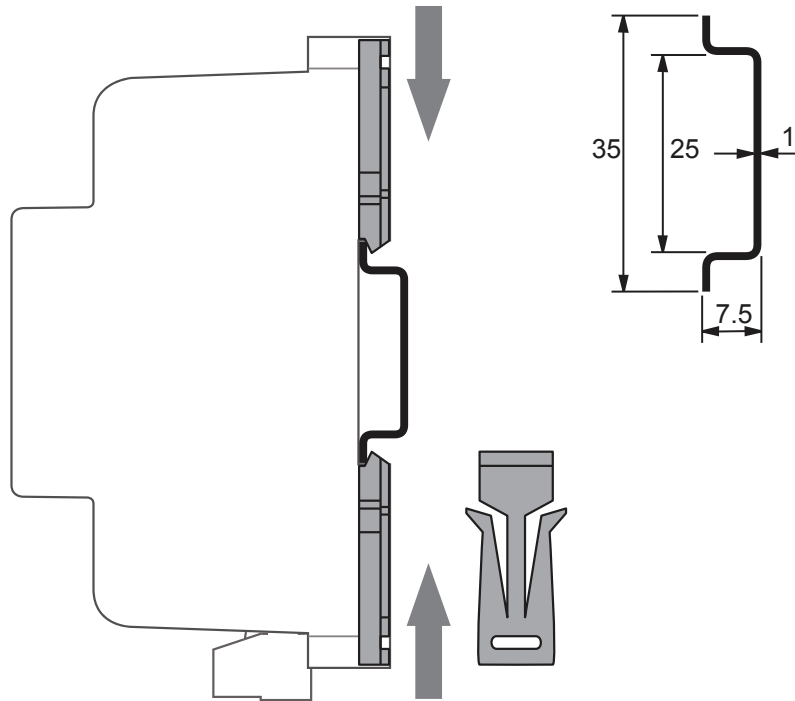

Node ID of CEA-709 Port 1

Virtual (Node) ID of CEA-852 port (Ethernet)

MAC address of CEA-852 Ethernet port

Serial number of the device

